

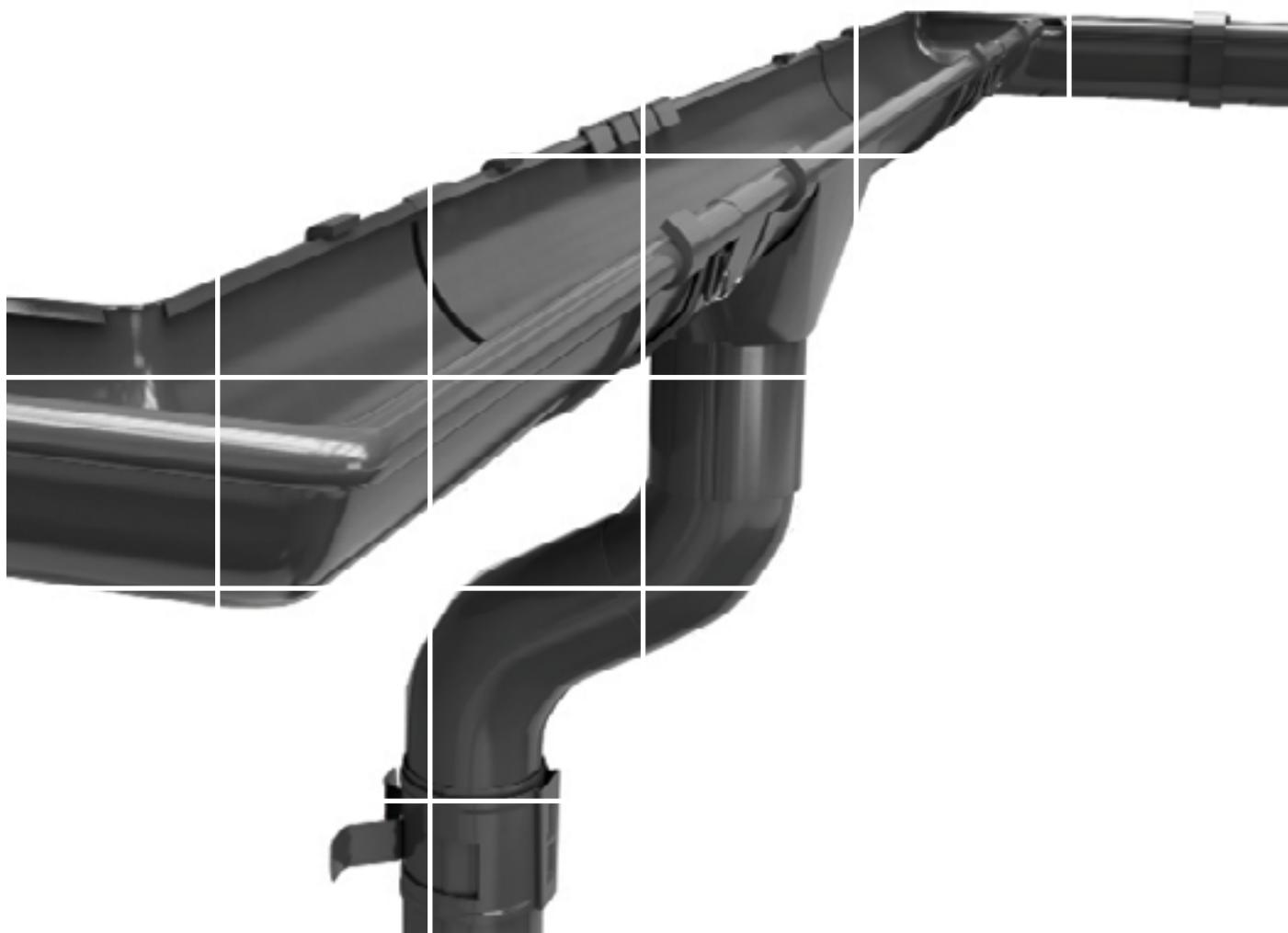

ECO
RAINLINE





A selection of optimal solutions



CONTENTS

01.	RAIKO® gutter system.....	04
02.	Rawmaterials.....	04
03.	System components.....	05
04.	Sizes and choice of colours	06
05.	Manufacturing process.....	07
06.	Relations with customers.....	07
07.	Assembly instructions.....	07
08.	System components - gutter.....	10
09.	System components - downpipe.....	11
10.	System components - connector 500 mm.....	12
11.	System components - connector 1000 mm.....	13
12.	System components - gutter joint.....	14
13.	System components - bottom.....	15
14.	System components - hook longer.....	16
15.	System components - hook long	17
16.	System components - hook medium.....	18
17.	System components - hook combi.....	19
18.	System components - external corner 90	20
19.	System components - external corner 135	21
20.	System components - internal corner 90.....	22
21.	System components - internal corner 135.....	23
22.	System components - hopper head.....	24
23.	System components - elbow.....	25
24.	System components - screwed clamping ring.....	26
25.	System components - clamping ring.....	27
26.	System components - pipe tee.....	28
27.	System components - rainwater catcher.....	29
28.	System components - flow out component.....	30
29.	System components - downpipe with flange.....	31
30.	Quantity and weight of the RAIKO® system components.....	33
31.	Quantity and weight of the RAIKO® system components	35



ECO RAINLINE GUTTER SYSTEM

ECO RAINLINE gutter system is a complete roof drainage system to be applied to any type of roof. Manufactured using the highest quality materials and with paying particular attention to details it will meet the needs of even the most demanding customers.

The materials used to manufacture the ECO RAINLINE gutter system provide an excellent compromise between endurance and appearance.

A wide selection of the offered system sizes and colours contributes to individual matching of the selected system to the roof surfaces and colours of the roof stretches.



RAW MATERIAL

The ECO RAINLINE gutter system components are manufactured from Arcelor Mittal's sheet metal material made according to the Granite® Rain HDS technology.

The ECO RAINLINE gutter system products are guaranteed against corrosion and to maintain all features of the layer appearance (on the exposed side) for up to 10 years.

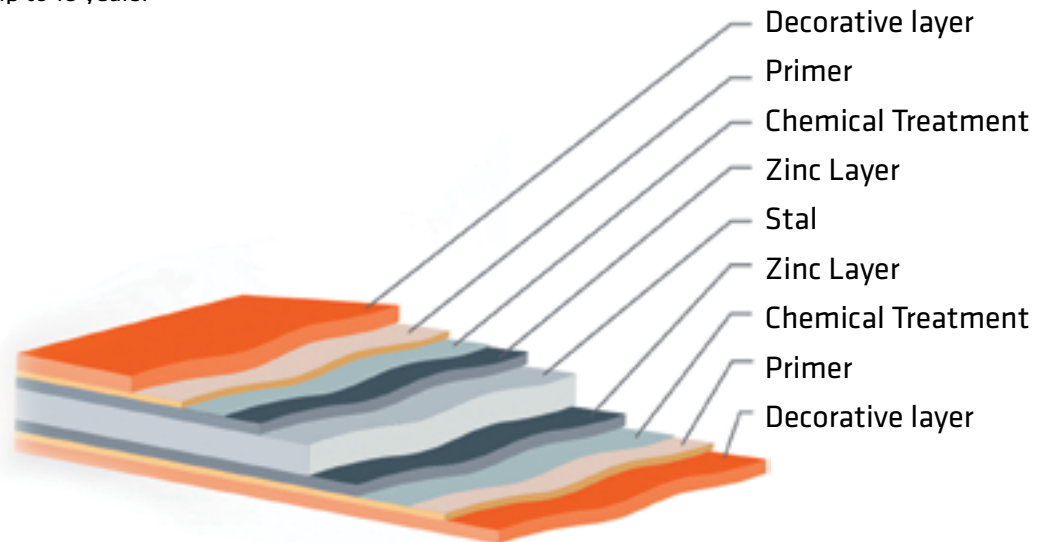



SYSTEM COMPONENTS

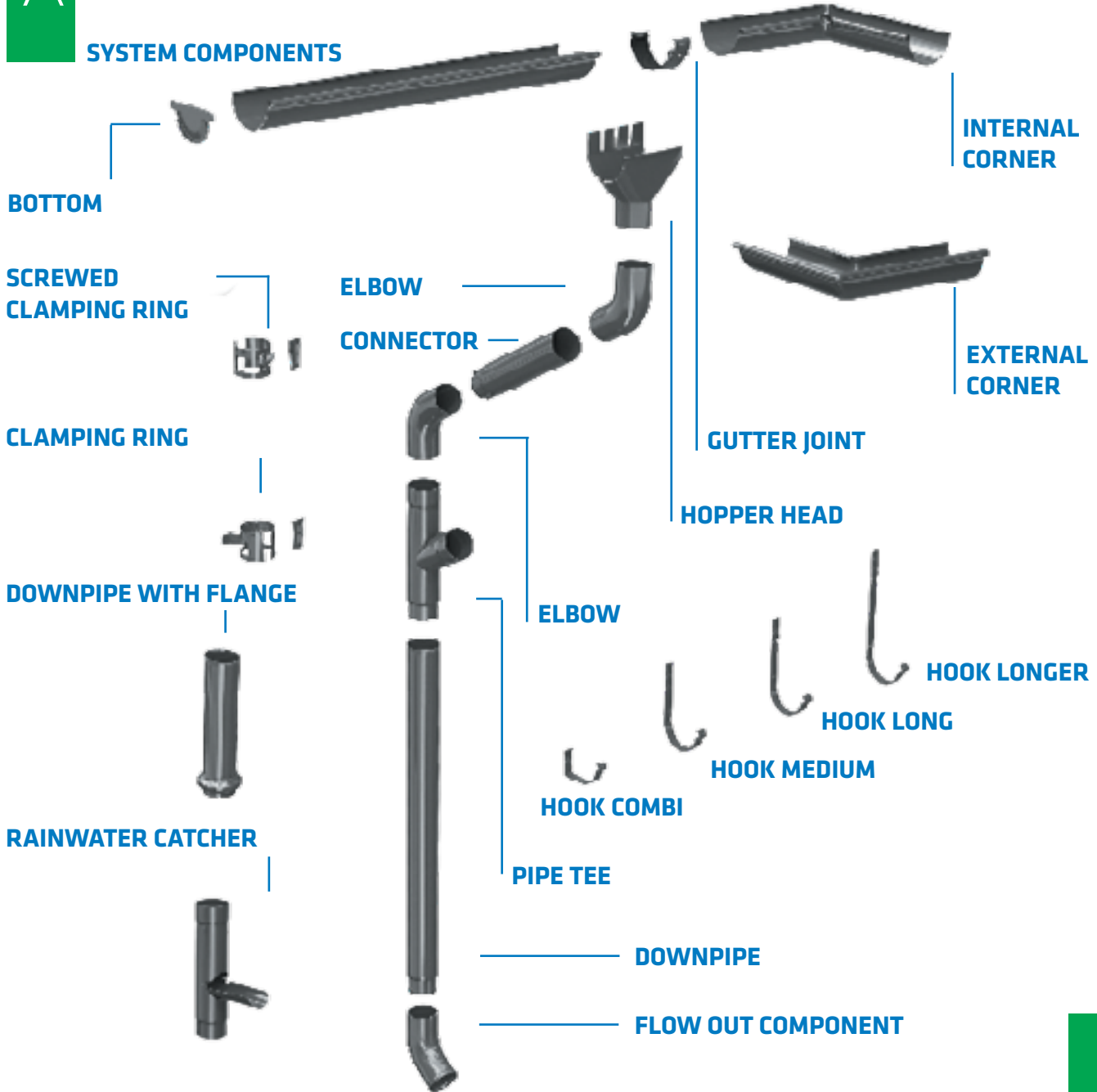

PARAMETER	VALUE	STANDARD
A APPLICATION	outdoors	-
B COAT THICKNESS	35 µm / 35 µm	ISO 2808
C ZINC COAT THICKNESS	Z275	ISO 2808
D GLOSS (GARDNER 60°)	30 or 40	EN 13523
E SCRATCH RESISTANCE	≥2	EN 13523
F COAT ADHESION	≤1	EN 13523
G COAT FLEXIBILITY	≤2	EN 13523
H CORROSION RESISTANT (salt spray chamber tested)	500 h (ISO 7253) / RC4	EN 10169
I UV RESISTANCE	2000 h (ISO 4892 - 3) / RUV4	EN 10169
J DEFORMABILITY	good	



SIZES & CHOICE OF COLOURS

The ECO RAINLINE gutter system is available in two sizes and 7 colours:

A 125MM / 90MM

B 150MM / 100MM

C AVAILABLE COLOURS

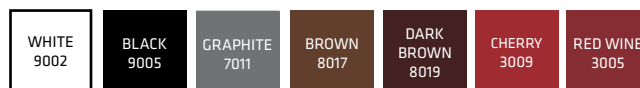

6

A wide choice of the offered system sizes and colours contribute to individual matching of the selected system to the roof surfaces and colours of the roof stretches.



MANUFACTURING PROCESS

The **RAIKO® PREMIUM gutter system** is made based on a state-of-the-art technology using sheet metal cold press forming operation. The production is carried out with a broad and continuously modernized machine stock operated by experienced staff. Highest care to perfectly match each detail and maintaining permanent high quality of production result in the system marketing success.



RELATIONS WITH CUSTOMERS

Your comments pertaining to application of the **RAIKO® ECO gutter system** are of great importance to us. This is why we would like you to use the company info line in order to obtain comprehensive answers to any of your concerns. We analyze all your observations very thoroughly, which allows us to determine new product development trends.



ASSEMBLY INSTRUCTIONS

Proper system assembly guarantees quick and complete water drainage from the whole roof slopes during the entire system service life and reduces maintenance operations to simply removing leaves from gutters. Therefore, in order to guarantee that you are fully satisfied with our product, below we attached assembly guidelines and hints. Please read them before you start assembling the **RAIKO® PREMIUM gutter system**.

EFFICIENCY TABLE OF RAIKO® GUTTER SYSTEM

GUTTER SYSTEM	ROOF AREA	
	1 DOWNPIPE	2 DOWNPIPES
125/90	50 m ² - 100 m ²	100 m ² - 150 m ²
150/100	100 m ² - 150 m ²	150 m ² - 200 m ²



ASSEMBLY INFORMATION:

Make sure you have a sufficient quantity of all the necessary system components on hand.

Remember that the gutter should stick out beyond the roof slope edge at least by half of its diameter.

Bear in mind that the gutter should be fitted slightly below the roof slope extension line so that it does not support snow sliding down from the roof.

Keep the gutter drop toward the downpipe by approximately 3-5mm per running meter.

Remember that the gutter's inside edge should be 6-10mm higher than its outside edge.



1

INSTALLATION OF HOOKS:

- Medium hooks (HKS), long hooks (HKD), and longer hooks (HKL) which are to be mounted onto rafters, laths, or boards should be bent in order to obtain the required gutter drop (3-5mm per running meter)
- Combi hooks (HKC) are used for direct mounting on fascia board, maintaining a suitable gutter drop (3-5mm per running metre)
- Hooks should be fitted every 60cm, end hooks should be mounted approximately 10 cm from the gutter ends.
- Remember to fit the hook on each side near the corner.
- Start mounting the hooks by fixing the end hooks, then pull a cord between them in order to show the fitting line for the other hooks.
- In case two downpipes are being used, start fixing the hooks from the middle point between them, providing a drop toward each of the downpipes.



2

HOPPER HEAD INSTALLATION:

- Mark location on the gutter where the downpipe will be fitted, then cut a hole using a hack-saw (Note: do not use an angle grinder for this purpose).
- Turn up cut edges outwards to facilitate water flow into the hopper head. Mount the hopper head (SZT) into the gutter, placing its bent edge into the gutter hole. Then press the component to the gutter and fix it by bending the box holders to the inside gutter edge.

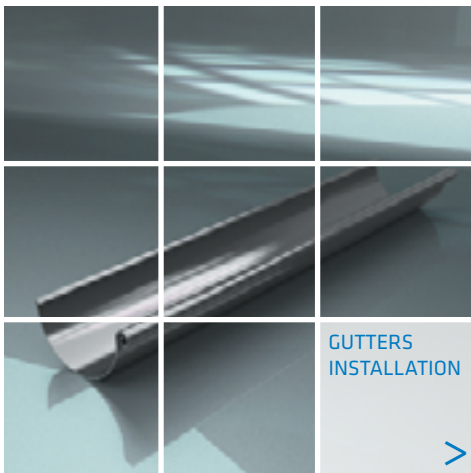

3 GUTTERS, ELBOWS AND BOTTOMS INSTALLATION:

- Mount gutters (RYN) and corners (NAW,NAZ) starting from the gutter with the mounted hopper head, and connect the gutter inside part to the holder onto a hook, and then press the outside edge into the lock. Then mount all other gutters and corners.
- Using a gutter joint (ZLR), seal all the joints between gutters and corners. Make sure that the joints are at even distances between the hooks.
- Place a gutter joint onto the back part of both components, making sure that the seal is in the middle of the joint.
- Then place a clamp on the front part of both components, closing the joint and securing it by bending the plate.
- Gutters and corners should be fitted with 2-3mm spacing between them in order to compensate for thermal elongation.
- Before fitting the bottoms (DEN) at the gutter ends, apply a small amount of roofing sealant in their vaulted pits. Then put the bottom in place and press down the front lug at the gutter overlap, and bend the back lug behind the gutter.

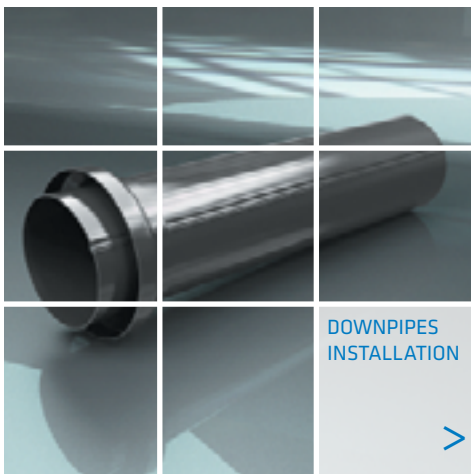

4 DOWNPIPES INSTALLATION:

- Mark a line on the wall, along which the downpipe will run. Next, mark the location of the gutter clamping ring (OBP) by placing it in there and prepare the fastening holes. Fix the clamping ring using strut pins. In the case of mounting onto a wall insulated with foamed polystyrene, use suitably long anchors (KTO) or pins (BDO).
- Mount the first clamping ring directly under the elbow and the last before the flow out component.
- Maximum distance between the clamping rings should not exceed 2mm. As soon as the pipes are fixed, put connectors onto the clamping rings using a wooden distance piece.
- Fix the flow out component (WYL) at the end of the downpipe. If the water is being discharged into the sewage system, use a flanged downpipe(RSK).

NOTE:

Remember to remove all the cut out pieces of sheet and fillings from the inside of the gutter. These leftover pieces will corrode and discolour the sheet metal surface



SYSTEM COMPONENTS

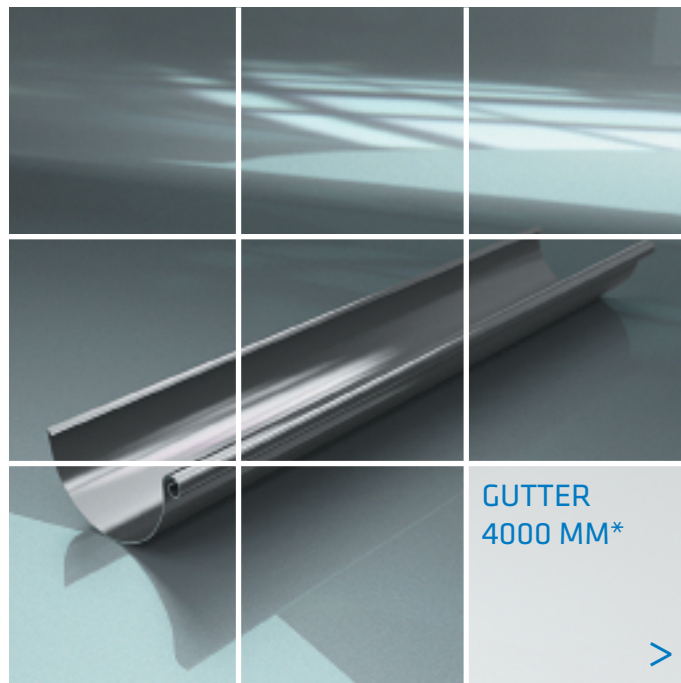
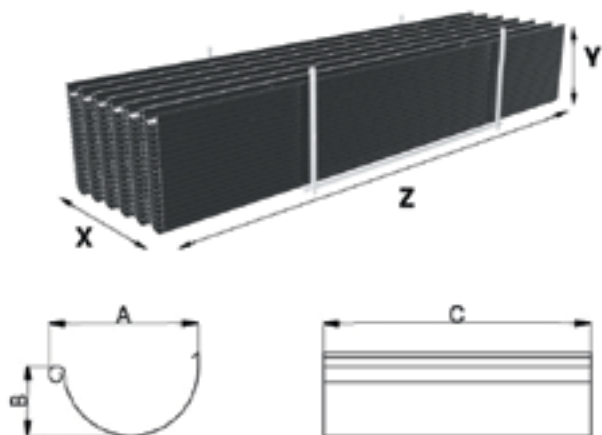

	COMPONENT SIZE (mm)			STAND SIZE (mm)		QUANTITY	
	125/90	150/100		125/90	150/100	125/90	150/100
A	125	150	X	790	790	5/200	5/150
B	66	74	Y	790	790	WEIGHT (KG)	
C	4000	4000	Z	4000	4000	4,26	4,88

*Our offer includes also 2000mm long gutter sections. The gutters can be cut to section lengths according to customer specification.

AVAILABLE COLOURS

10

WHITE 9002	BLACK 9005	GRAPHITE 7011	BROWN 8017	DARK BROWN 8019	CHERRY 3009	RED WINE 3005
---------------	---------------	------------------	---------------	-----------------------	----------------	------------------

ACCURATE PACKING

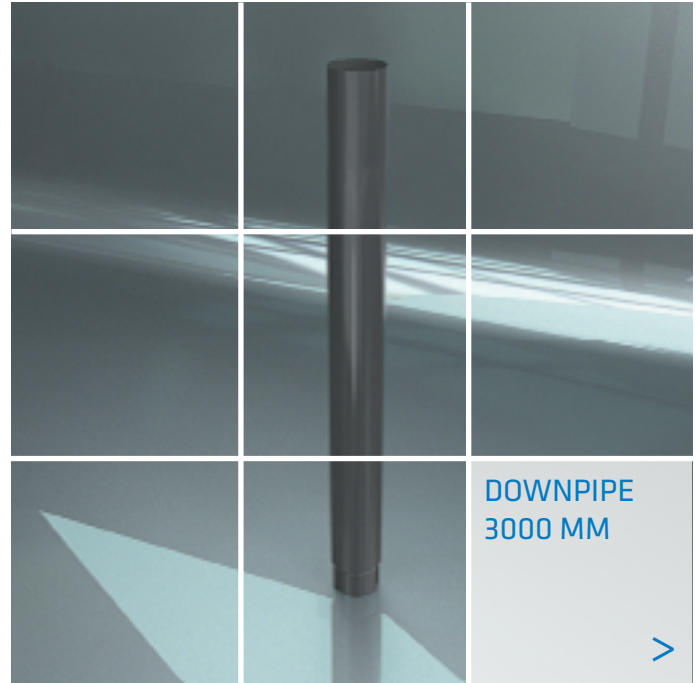
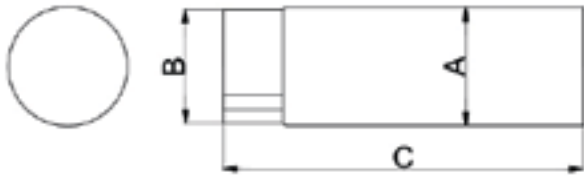
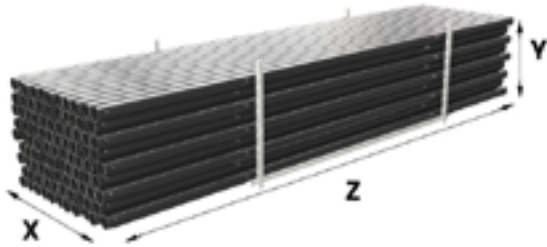

COMPONENT SIZE (mm)			STAND SIZE (mm)			QUANTITY	
	125/90	150/100	125/90	150/100	125/90	150/100	
A	87	99	X	790	790	2/44	2/34
B	85	96	Y	790	790	WEIGHT (KG)	
C	3000	3000	Z	3000	3000	3,9	4,41

*Our offer includes also 1000 mm, 2000 mm and 4000 mm long gutter sections. The gutters can be cut to section lengths according to customer specification.

AVAILABLE COLOURS

WHITE 9002	BLACK 9005	GRAPHITE 7011	BROWN 8017	DARK BROWN 8019	CHERRY 3009	RED WINE 3005
---------------	---------------	------------------	---------------	--------------------	----------------	------------------



SYSTEM COMPONENTS

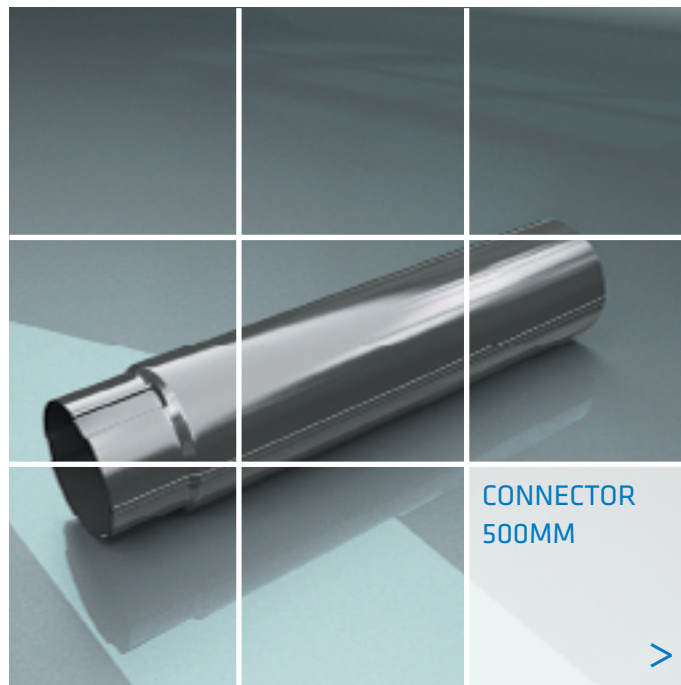

	COMPONENT SIZE (mm)			BOX SIZE (mm)		QUANTITY	
	125/90	150/100		125/90	150/100	125/90	150/100
A	87	99	X	390	390	16	13
B	85	96	Y	550	550	WEIGHT (KG)	
C	500	500	Z	390	390	0,65	0,73

AVAILABLE COLOURS

12

WHITE 9002	BLACK 9005	GRAPHITE 7011	BROWN 8017	DARK BROWN 8019	CHERRY 3009	RED WINE 3005
---------------	---------------	------------------	---------------	-----------------------	----------------	------------------

PERFECT FOR EACH ROOF

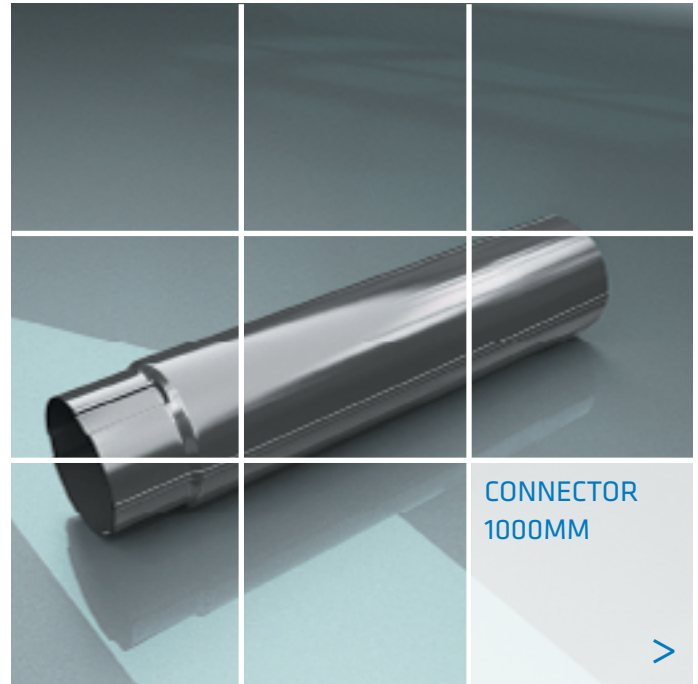
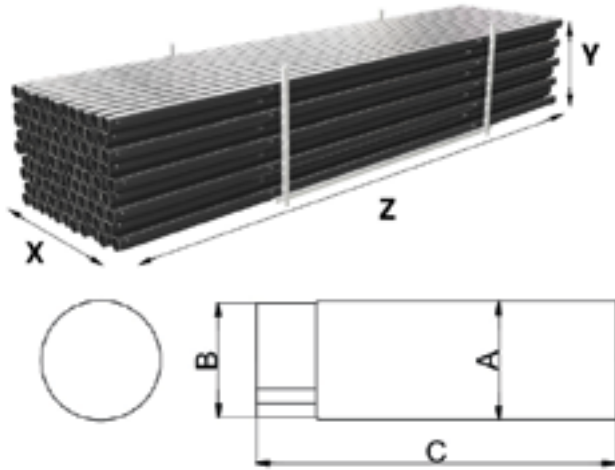

CONNECTOR
1000MM



	COMPONENT SIZE (mm)			STAND SIZE (mm)		QUANTITY	
	125/90	150/100		125/90	150/100	125/90	150/100
A	87	99	X	790	790	150	120
B	85	96	Y	1000	1000	WEIGHT (KG)	
C	1000	1000	Z	2000	2000	1,30	1,47

AVAILABLE COLOURS

WHITE 9002	BLACK 9005	GRAPHITE 7011	BROWN 8017	DARK BROWN 8019	CHERRY 3009	RED WINE 3005
---------------	---------------	------------------	---------------	--------------------	----------------	------------------



SYSTEM COMPONENTS

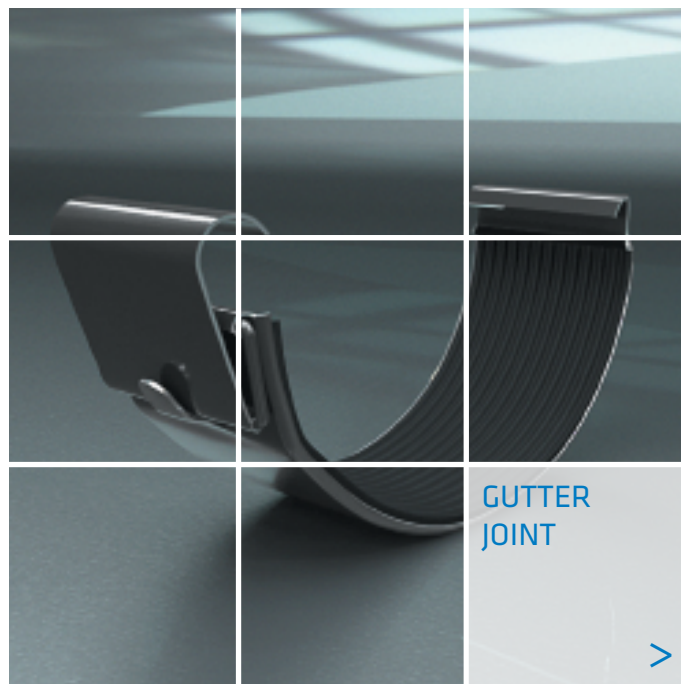
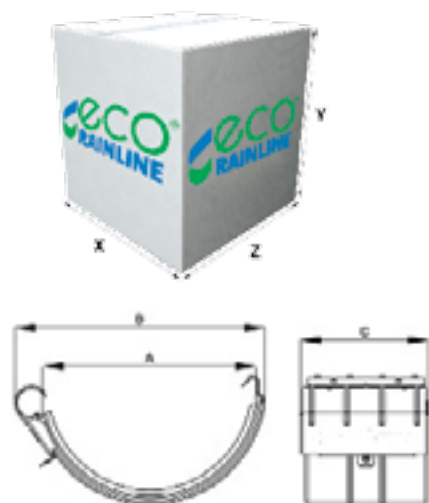

	COMPONENT SIZE (mm)			BOX SIZE (mm)		QUANTITY	
	125/90	150/100		125/90	150/100	125/90	150/100
A	125	150	X	390	390	50	50
B	145	175	Y	140	140	WEIGHT (KG)	
C	52	53	Z	390	390	0,12	0,185

AVAILABLE COLOURS

14

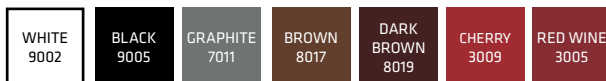

INVOLVEMENT INTO PRODUCTION

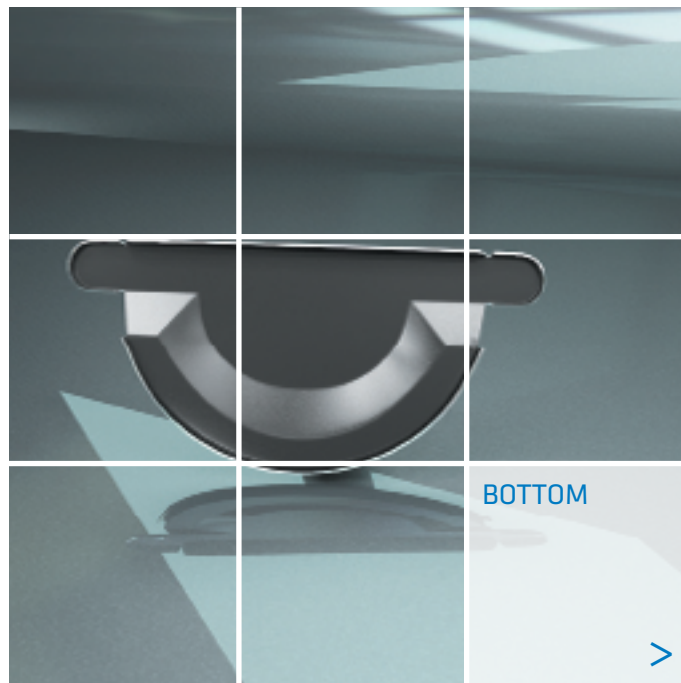
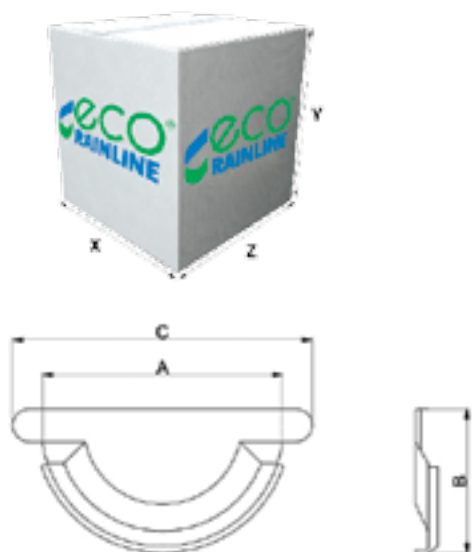

	COMPONENT SIZE (mm)			BOX SIZE (mm)		QUANTITY	
	125/90	150/100		125/90	150/100	125/90	150/100
A	125	150	X	390	390	100	100
B	69	79	Y	140	140	WEIGHT (KG)	
C	165	192	Z	390	390	0,054	0,070

AVAILABLE COLOURS

WHITE 9002	BLACK 9005	GRAPHITE 7011	BROWN 8017	DARK BROWN 8019	CHERRY 3009	RED WINE 3005
---------------	---------------	------------------	---------------	-----------------------	----------------	------------------



SYSTEM COMPONENTS

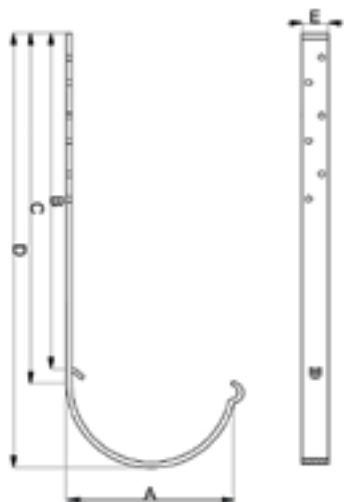

	COMPONENT SIZE (mm)			BOX SIZE (mm)		QUANTITY	
	125/90	150/100		125/90	150/100	125/90	150/100
A	125	150	X	390	390	50	50
B	305	305	Y	140	140	WEIGHT (KG)	
C	325	325	Z	600	600	0,56	0,58
D	395	400					
E	25	25					

AVAILABLE COLOURS

16

WHITE 9002	BLACK 9005	GRAPHITE 7011	BROWN 8017	DARK BROWN 8019	CHERRY 3009	RED WINE 3005
---------------	---------------	------------------	---------------	-----------------------	----------------	------------------

CLOSE COOPERATION WITH THE CLIENTS

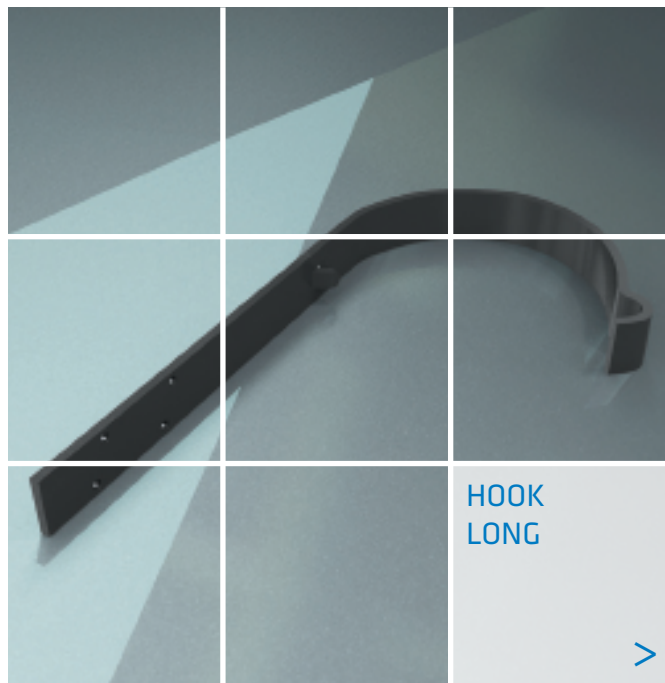
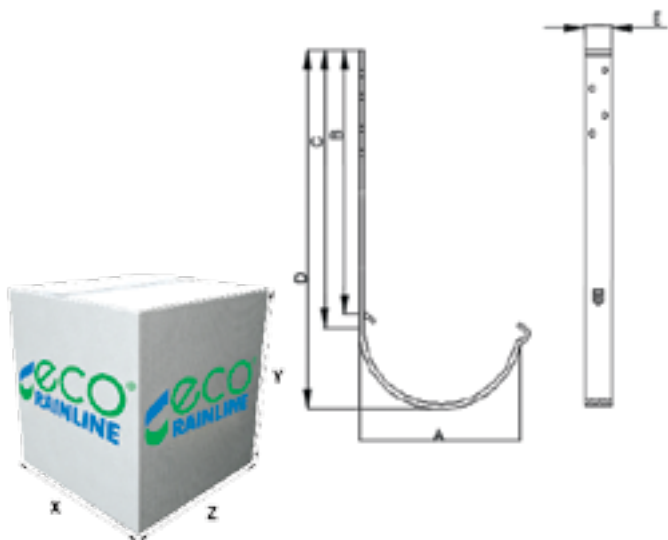

	COMPONENT SIZE (mm)			BOX SIZE (mm)		QUANTITY	
	125/90	150/100		125/90	150/100	125/90	150/100
A	125	150	X	390	390	50	50
B	190	190	Y	140	140	WEIGHT (KG)	
C	210	210	Z	390	390	0,430	0,467
D	285	285					
E	25	25					

AVAILABLE COLOURS

WHITE 9002	BLACK 9005	GRAPHITE 7011	BROWN 8017	DARK BROWN 8019	CHERRY 3009	RED WINE 3005
---------------	---------------	------------------	---------------	-----------------------	----------------	------------------



SYSTEM COMPONENTS

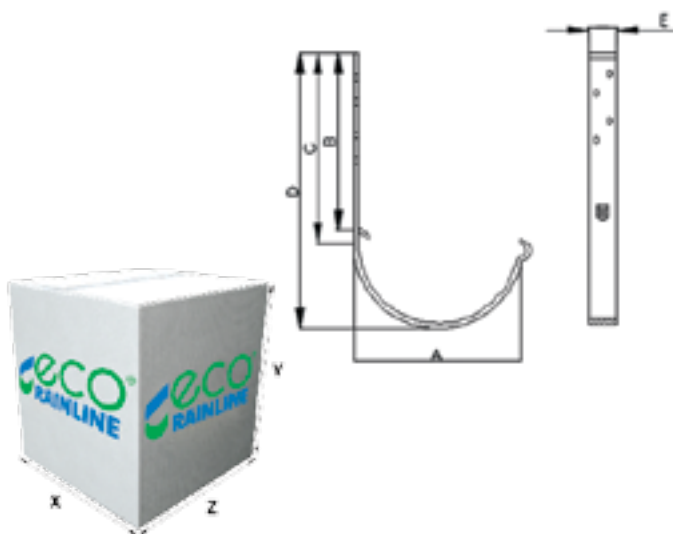

	COMPONENT SIZE (mm)			BOX SIZE (mm)		QUANTITY	
	125/90	150/100		125/90	150/100	125/90	150/100
A	125	150	X	390	390	50	50
B	145	145	Y	140	140	WEIGHT (KG)	
C	175	175	Z	390	390	0,382	0,434
D	240	240					
E	25	25					

AVAILABLE COLOURS

18

WHITE 9002	BLACK 9005	GRAPHITE 7011	BROWN 8017	DARK BROWN 8019	CHERRY 3009	RED WINE 3005
---------------	---------------	------------------	---------------	-----------------------	----------------	------------------

MATCH ANY CLIMATE

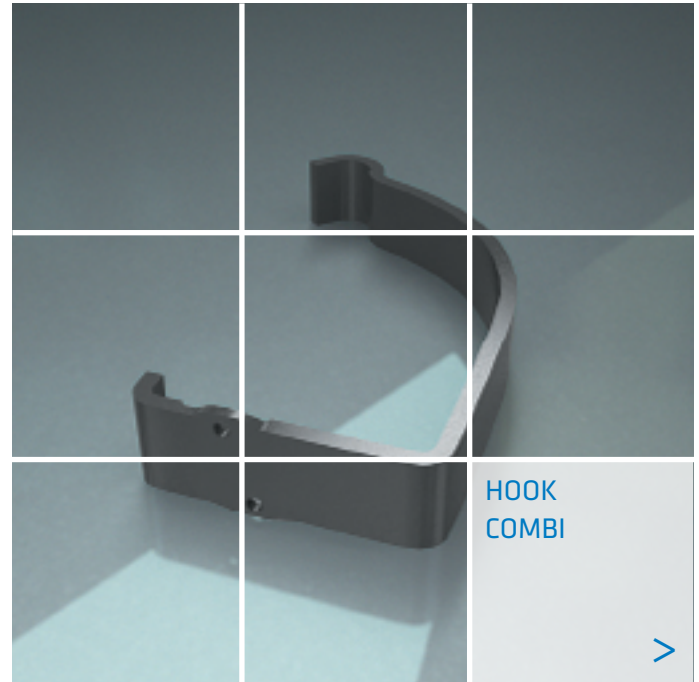
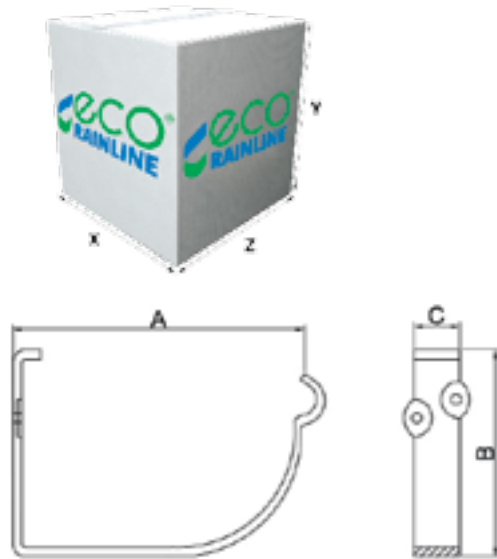

	COMPONENT SIZE (mm)			BOX SIZE (mm)		QUANTITY	
	125/90	150/100		125/90	150/100	125/90	150/100
A	125	150	X	390	390	50	50
B	81	91	Y	140	140	WEIGHT (KG)	
C	25	25	Z	390	390	0,274	0,315

AVAILABLE COLOURS

WHITE 9002	BLACK 9005	GRAPHITE 7011	BROWN 8017	DARK BROWN 8019	CHERRY 3009	RED WINE 3005
---------------	---------------	------------------	---------------	--------------------	----------------	------------------



SYSTEM COMPONENTS

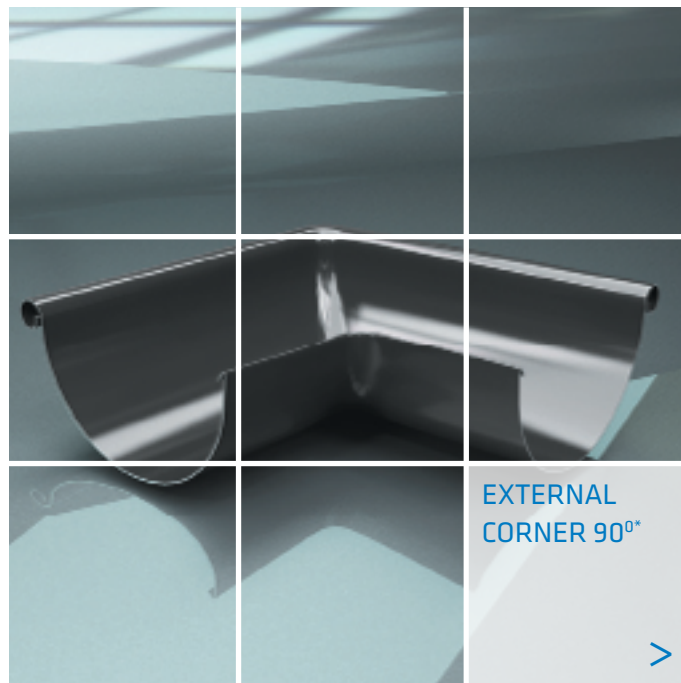
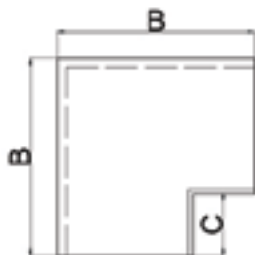
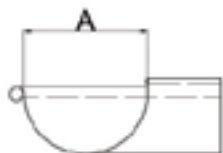

EXTERNAL
CORNER 90°*



	COMPONENT SIZE (mm)			BOX SIZE (mm)		QUANTITY	
	125/90	150/100		125/90	150/100	125/90	150/100
A	125	150	X	390	390	30	15
B	245	270	Y	410	410	WEIGHT (KG)	
C	111	100	Z	390	390	0,366	0,47

*We can fabricate welded gutter mitres in accordance with the customer specified angular dimensions, other than typical 90 and 135 degree gutter mitres.

AVAILABLE COLOURS

20

WHITE 9002	BLACK 9005	GRAPHITE 7011	BROWN 8017	DARK BROWN 8019	CHERRY 3009	RED WINE 3005
---------------	---------------	------------------	---------------	-----------------------	----------------	------------------

EASY TO ASSEMBLE

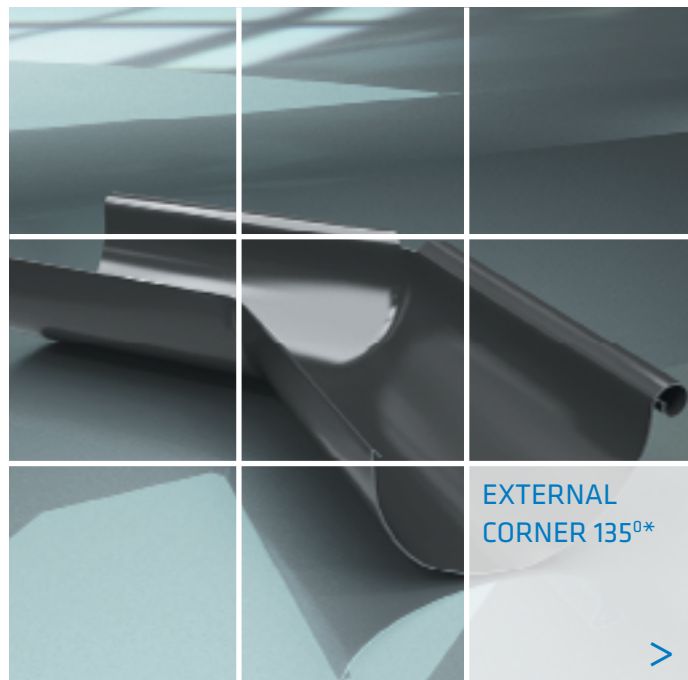
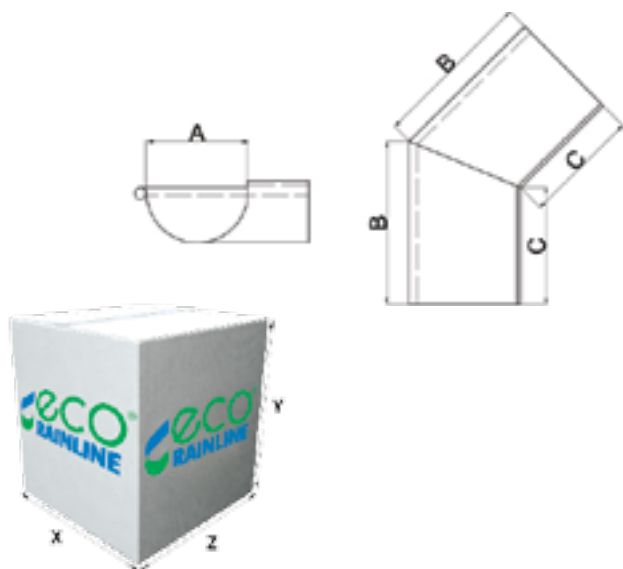

	COMPONENT SIZE (mm)			BOX SIZE (mm)		QUANTITY	
	125/90	150/100		125/90	150/100	125/90	150/100
A	125	150	X	390	390	15	5
B	245	300	Y	410	140	WEIGHT (KG)	
C	180	230	Z	390	600	0,478	0,90

*We can fabricate welded gutter mitres in accordance with the customer specified angular dimensions, other than typical 90 and 135 degree gutter mitres.

AVAILABLE COLOURS

WHITE 9002	BLACK 9005	GRAPHITE 7011	BROWN 8017	DARK BROWN 8019	CHERRY 3009	RED WINE 3005
---------------	---------------	------------------	---------------	-----------------------	----------------	------------------



SYSTEM COMPONENTS

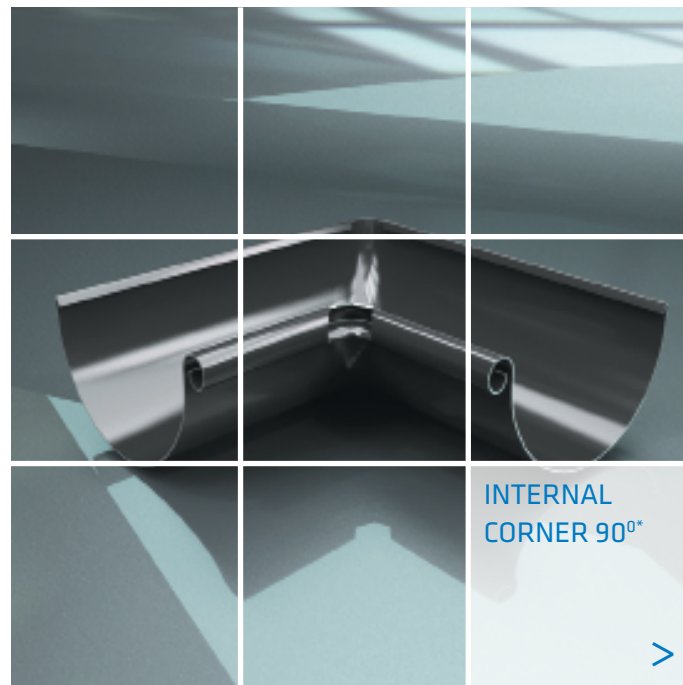
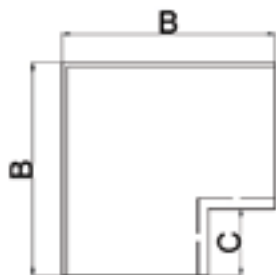
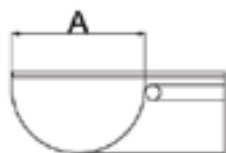

INTERNAL
CORNER 90°*

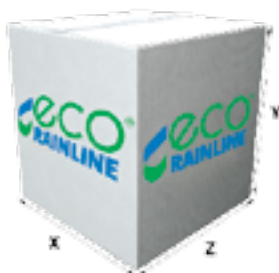

	COMPONENT SIZE (mm)			BOX SIZE (mm)		QUANTITY	
	125/90	150/100		125/90	150/100	125/90	150/100
A	125	150	X	390	390	30	15
B	230	325	Y	410	410	WEIGHT (KG)	
C	100	165	Z	390	390	0,314	0,409

*We can fabricate welded gutter mitres in accordance with the customer specified angular dimensions, other than typical 90 and 135 degree gutter mitres.

AVAILABLE COLOURS

22

WHITE 9002	BLACK 9005	GRAPHITE 7011	BROWN 8017	DARK BROWN 8019	CHERRY 3009	RED WINE 3005
---------------	---------------	------------------	---------------	-----------------------	----------------	------------------

HIGHEST QUALITY STEEL

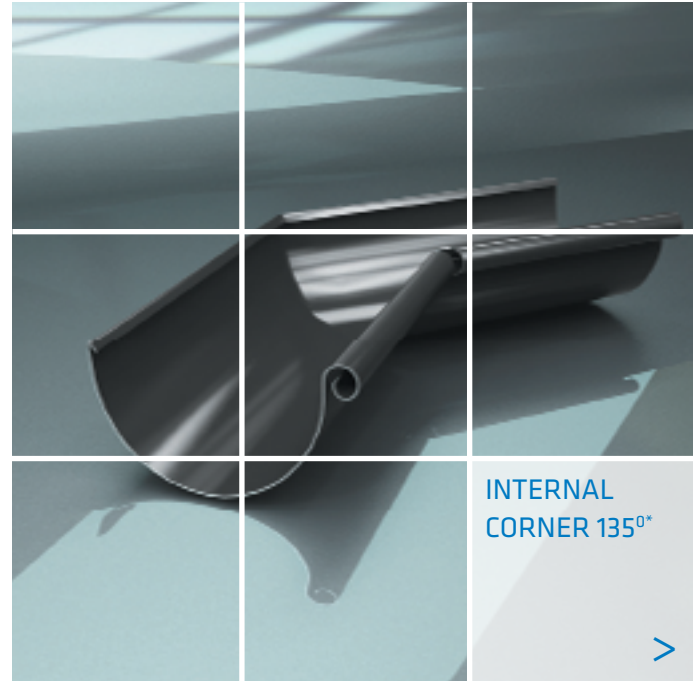
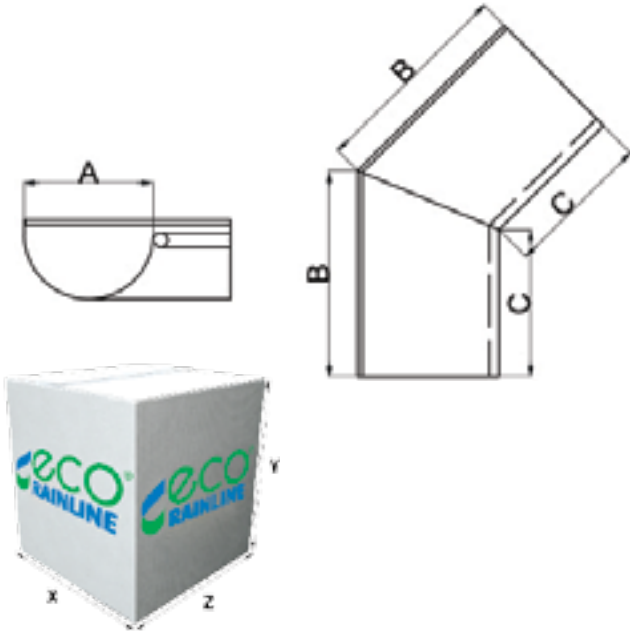

	COMPONENT SIZE (mm)			BOX SIZE (mm)		QUANTITY	
	125/90	150/100		125/90	150/100	125/90	150/100
A	125	150	X	390	390	15	5
B	240	305	Y	410	140	WEIGHT (KG)	
C	185	245	Z	390	600	0,314	0,85

*We can fabricate welded gutter mitres in accordance with the customer specified angular dimensions, other than typical 90 and 135 degree gutter mitres.

AVAILABLE COLOURS

WHITE 9002	BLACK 9005	GRAPHITE 7011	BROWN 8017	DARK BROWN 8019	CHERRY 3009	RED WINE 3005
---------------	---------------	------------------	---------------	--------------------	----------------	------------------



SYSTEM COMPONENTS

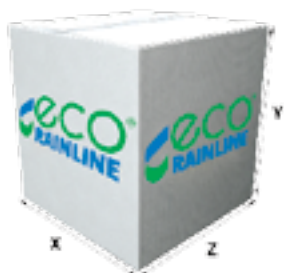
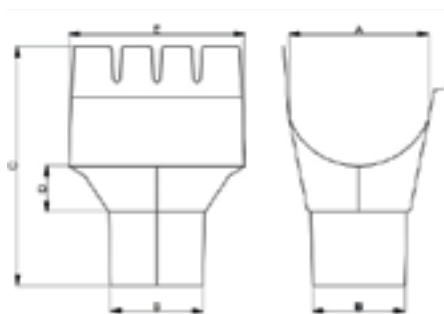

	COMPONENT SIZE (mm)		BOX SIZE (mm)		QUANTITY		
	125/90	150/100	125/90	150/100	125/90	150/100	
A	125	150	X	390	390	30	16
B	86	97	Y	410	410	WEIGHT (KG)	
C	220	250	Z	390	390	0,29	0,4
D	60	60					
E	150	180					

AVAILABLE COLOURS

24

WHITE 9002	BLACK 9005	GRAPHITE 7011	BROWN 8017	DARK BROWN 8019	CHERRY 3009	RED WINE 3005
---------------	---------------	------------------	---------------	-----------------------	----------------	------------------

LONG-TERM DURABILITY

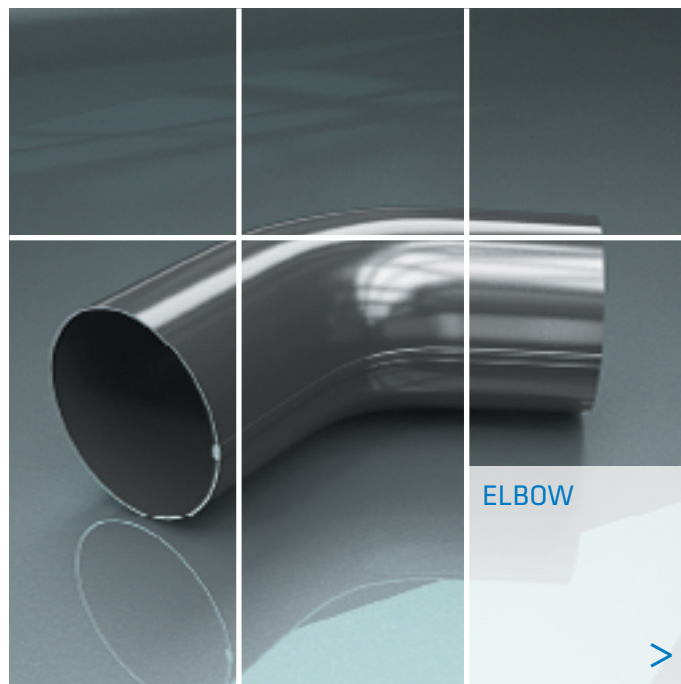
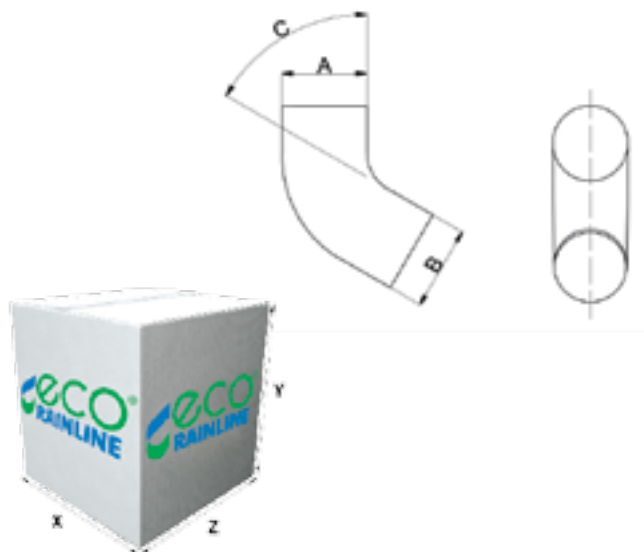

ELBOW



	COMPONENT SIZE (mm)			BOX SIZE (mm)		QUANTITY	
	125/90	150/100		125/90	150/100	125/90	150/100
A	125	150	X	390	390	20	16
B	240	305	Y	410	410	WEIGHT (KG)	
C	60°	60°	Z	390	390	0,285	0,33

AVAILABLE COLOURS

WHITE 9002	BLACK 9005	GRAPHITE 7011	BROWN 8017	DARK BROWN 8019	CHERRY 3009	RED WINE 3005
---------------	---------------	------------------	---------------	--------------------	----------------	------------------



SYSTEM COMPONENTS

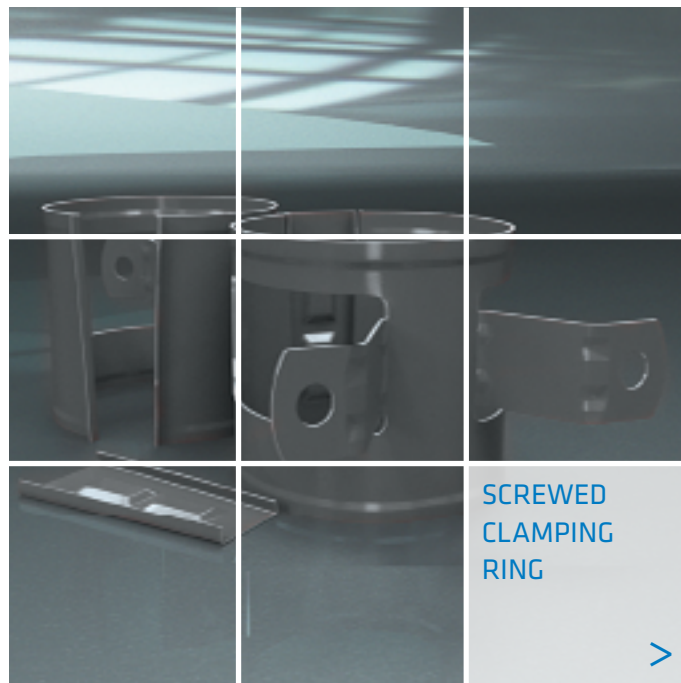
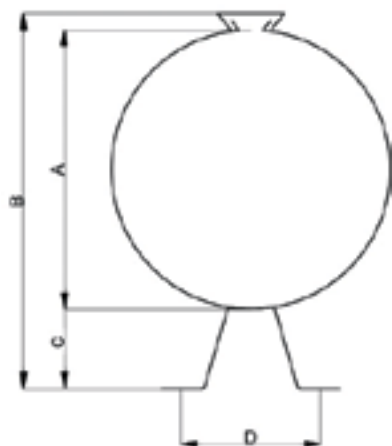

	COMPONENT SIZE (mm)			BOX SIZE (mm)		QUANTITY	
	125/90	150/100		125/90	150/100	125/90	150/100
A	88	99	X	390	390	100	100
B	125	140	Y	140	140	WEIGHT (KG)	
C	35	35	Z	390	390	0,095	0,108
D	87,6	87,6					

AVAILABLE COLOURS

26

WHITE 9002	BLACK 9005	GRAPHITE 7011	BROWN 8017	DARK BROWN 8019	CHERRY 3009	RED WINE 3005
---------------	---------------	------------------	---------------	--------------------	----------------	------------------

PERFECT FOR EACH ROOF

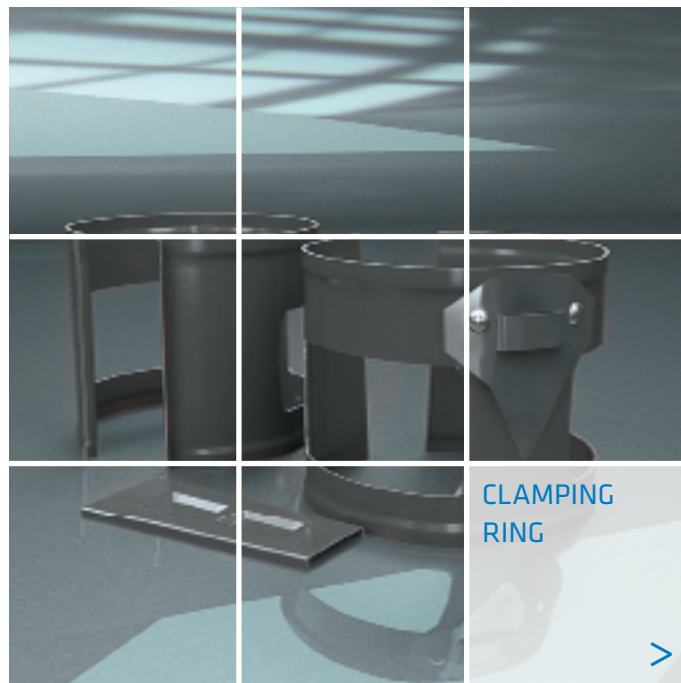
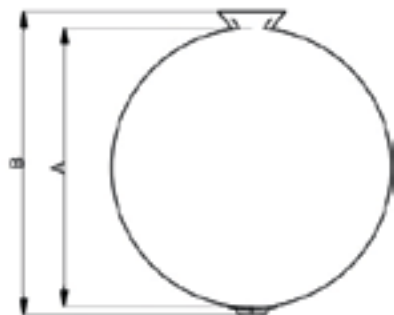
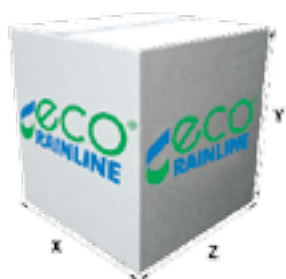

	COMPONENT SIZE (mm)			BOX SIZE (mm)		QUANTITY	
	125/90	150/100		125/90	150/100	125/90	150/100
A	125	150	X	390	390	100	100
B	240	305	Y	140	140	WEIGHT (KG)	
			Z	390	390	0,097	0,111

AVAILABLE COLOURS

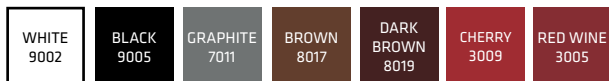



SYSTEM COMPONENTS

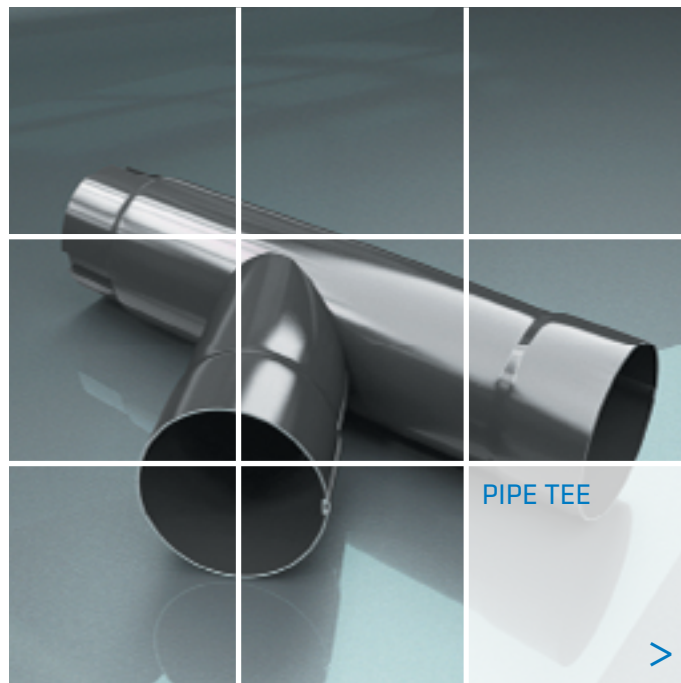
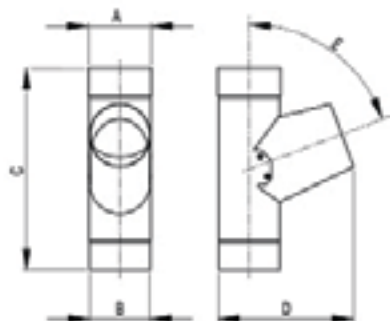
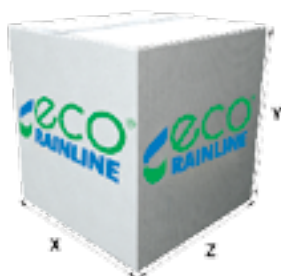

COMPONENT SIZE (mm)

BOX SIZE (mm)

QUANTITY

125/90 150/100

125/90 150/100

125/90 150/100

A 89 100 **X** 390 390 10 8

B 85 96 **Y** 410 410 **WEIGHT (KG)**

C 370 380 **Z** 390 390 0,65 0,768

D 220 230

E 65° 65°

AVAILABLE COLOURS

28

WHITE
9002

BLACK
9005

GRAPHITE
7011

BROWN
8017

DARK
BROWN
8019

CHERRY
3009

RED WINE
3005

COMPLETE DRAINAGE SYSTEM

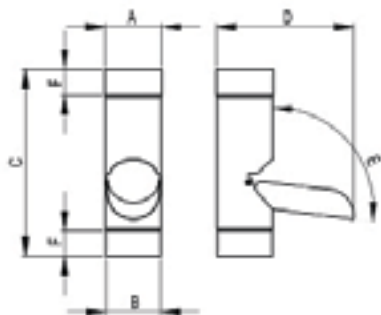
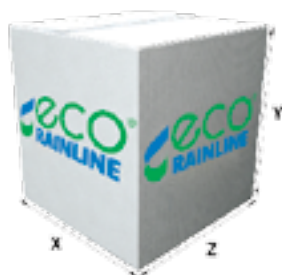
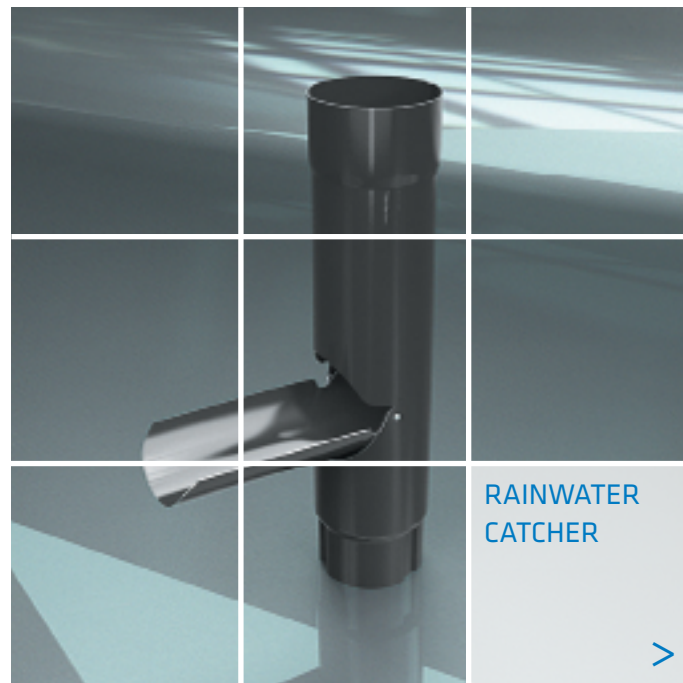

	COMPONENT SIZE (mm)			BOX SIZE (mm)		QUANTITY	
	125/90	150/100		125/90	150/100	125/90	150/100
A	89	101	X	390	390	10	8
B	86	97	Y	410	410	WEIGHT (KG)	
C	330	330	Z	390	390	0,64	0,56
D	120	121					
E	100°	100°					

AVAILABLE COLOURS

WHITE 9002	BLACK 9005	GRAPHITE 7011	BROWN 8017	DARK BROWN 8019	CHERRY 3009	RED WINE 3005
---------------	---------------	------------------	---------------	--------------------	----------------	------------------



SYSTEM COMPONENTS

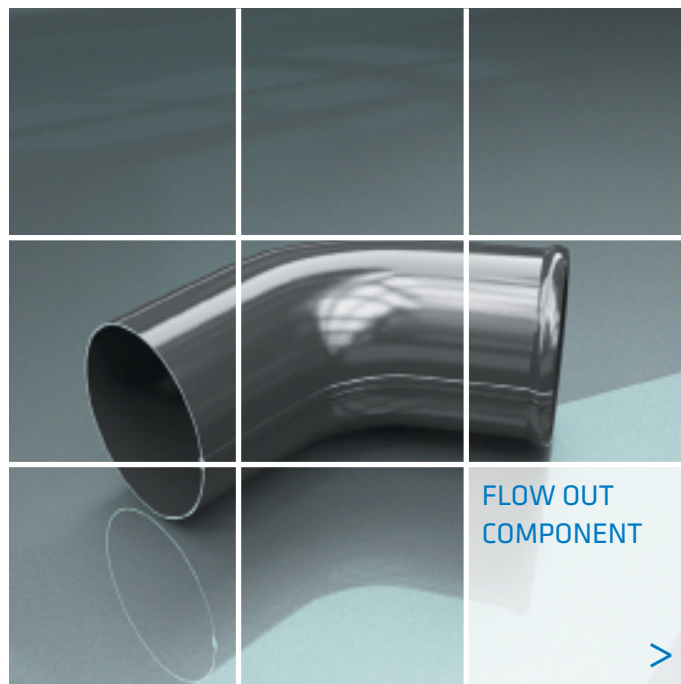
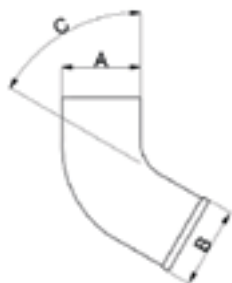

	COMPONENT SIZE (mm)			BOX SIZE (mm)		QUANTITY	
	125/90	150/100		125/90	150/100	125/90	150/100
A	87	101	X	390	390	20	16
B	88,5	99,5	Y	410	410	WEIGHT (KG)	
C	60°	60°	Z	390	390	0,285	0,33

AVAILABLE COLOURS

30

WHITE 9002	BLACK 9005	GRAPHITE 7011	BROWN 8017	DARK BROWN 8019	CHERRY 3009	RED WINE 3005
---------------	---------------	------------------	---------------	-----------------------	----------------	------------------

VARIETY OF COLOURS

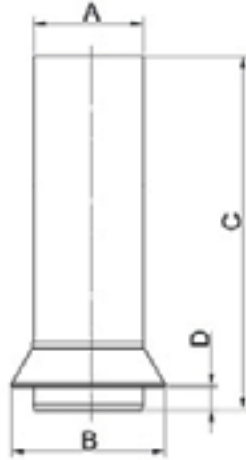

	COMPONENT SIZE (mm)			BOX SIZE (mm)		QUANTITY	
	125/90	150/100		125/90	150/100	125/90	150/100
A	87	99	X	390	390	12	9
B	115	125	Y	410	410	WEIGHT (KG)	
C	400	400	Z	390	390	0,64	0,635
D	30	30					

AVAILABLE COLOURS

WHITE 9002	BLACK 9005	GRAPHITE 7011	BROWN 8017	DARK BROWN 8019	CHERRY 3009	RED WINE 3005
---------------	---------------	------------------	---------------	--------------------	----------------	------------------

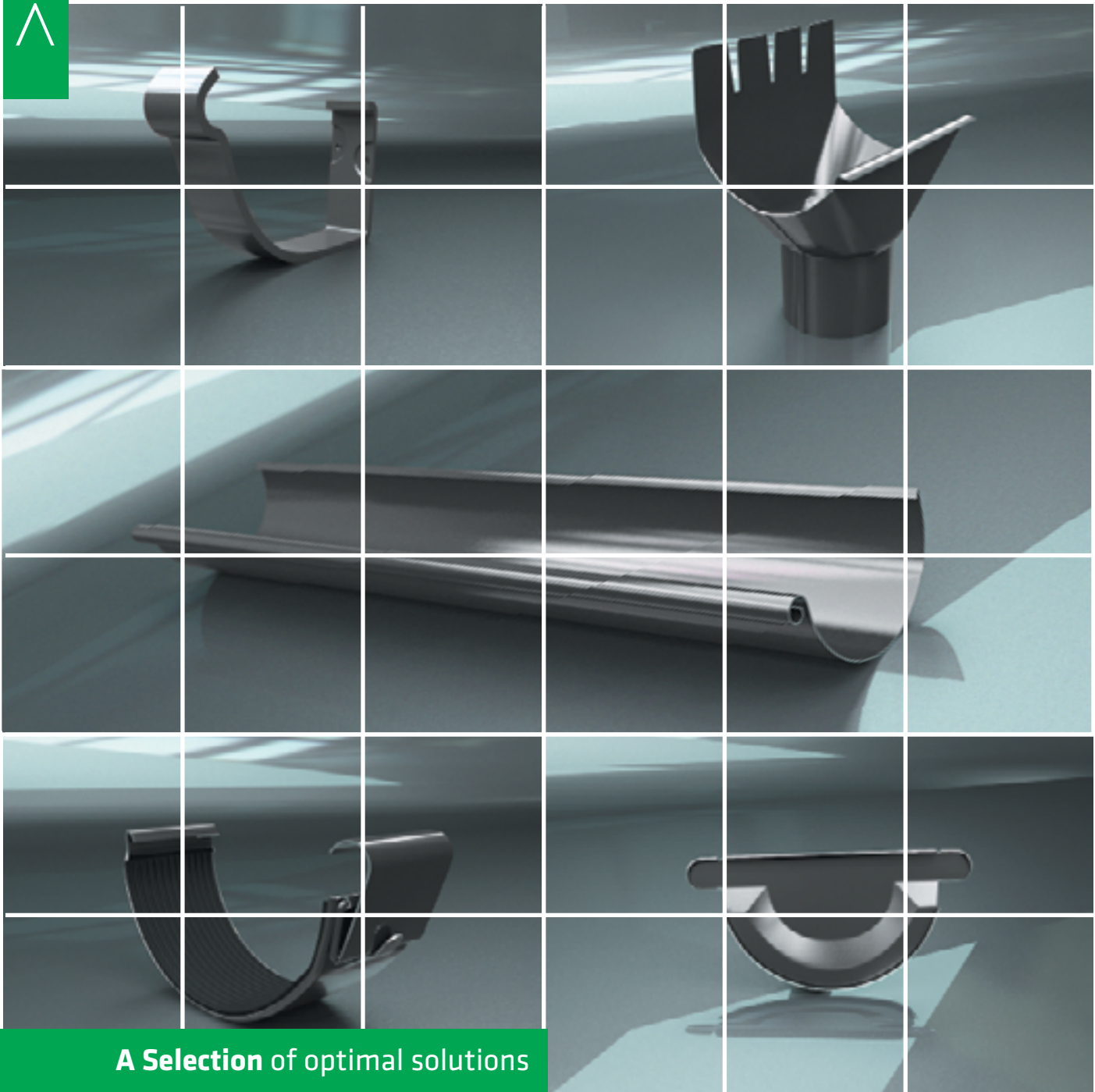

A Selection of optimal solutions



QUANTITY AND WEIGHT OF THE RAIKO® GUTTER SYSTEM COMPONENTS IN COLLECTIVE PACKAGING

PRODUCT NAME		SIZE	125/90		150/100	
			Q-TY IN PCS	WEIGHT IN KG	Q-TY IN PCS	WEIGHT IN KG
A	GUTTER	L = 2 m	5 ¹ /200 ²	5,65/426	5 ¹ /150 ²	12,2/366
		L = 4 m	5 ¹ /200 ²	11,3/852	5 ¹ /150 ²	24,4/732
B	CORNER	external	30 ³ /900 ⁵	9,42/283	15 ³ /450 ⁵	6,2/184
		internal	30 ³ /900 ⁵	11/330	15 ³ /360 ⁵	7,05/211,5
C	BOTTOM	uniwersal	50 ⁴ /6000 ⁶	5,4/324	50 ⁴ /6000 ⁶	7,0/420
D	GUTTER JOINT		50 ⁴ /3000 ⁶	6/360	50 ⁴ /3000 ⁶	9,25/555
E	HOOK	combi	50 ⁴ /1800 ⁶	13,7/493	50 ⁴ /1800 ⁶	15,8/567
		medium	50 ⁴ /1800 ⁶	19,1/687,5	50 ⁴ /1800 ⁶	21,7/781
		long	50 ⁴ /1800 ⁶	21,5/774	50 ⁴ /1800 ⁶	23,4/840
		longer	50 ⁴ /1200 ⁶	28/672	50 ⁴ /1200 ⁶	29/696
F	HOPPER HEAD		30 ³ /900 ⁵	8,7/261	16 ³ /480 ⁵	6,4/192

¹ fail sleeve

² metal stand 80 cm/ element length/ 80 cm

³ carton 40 cm / 40 cm / 40 cm

⁴ carton 40 cm / 40 cm / 16 cm

⁵ EURO pallet 80 cm / 120 cm / 200 cm

⁶ EURO pallet 80 cm / 120 cm / 84 cm

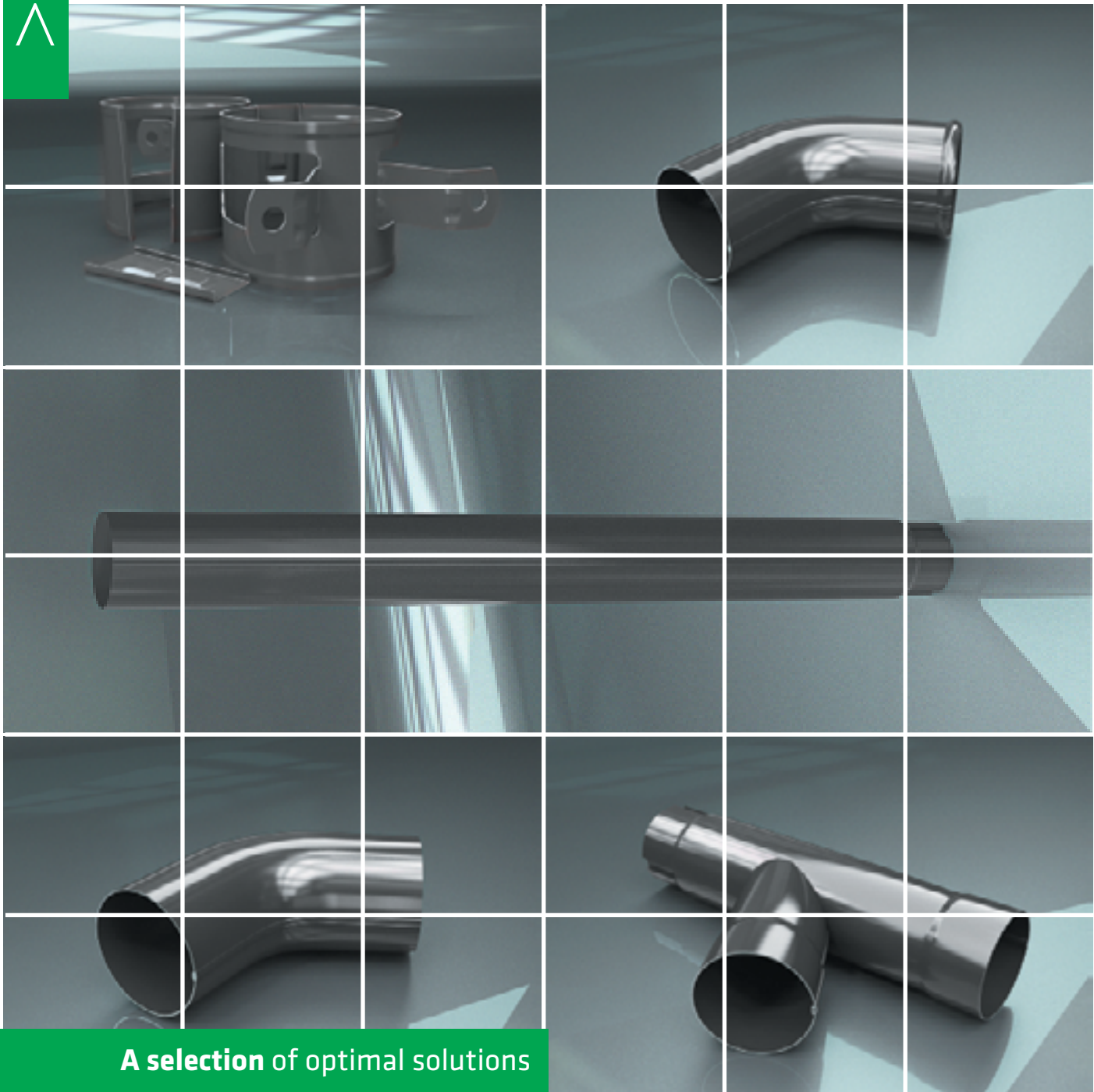

A selection of optimal solutions



QUANTITY AND WEIGHT OF THE RAIKO® GUTTER SYSTEM COMPONENTS IN COLLECTIVE PACKAGING

PRODUCT NAME		SIZE	125/90		150/100	
			Q-TY IN PCS	WEIGHT IN KG	Q-TY IN PCS	WEIGHT IN KG
A	ELBOW	ANGLE = 60 ⁰	20 ³ /600 ⁵	5,7/171	16 ³ /480 ⁵	5,28/158,4
B	CONNECTOR	0,5 m	16 ³ /384 ⁵	10,4/249,6	13 ³ /312 ⁵	9,5/228
		1,0 m	2 ³ /150 ⁵	2,6/195	2 ³ /120 ⁵	2,94/176,5
C	DOWNPIPE	L = 1 m	2 ³ /150 ⁵	2,6/195	2 ³ /120 ⁵	2,94/176,5
		L = 3 m	2 ¹ /44 ²	7,8/171,6	2 ¹ /34 ²	8,82/150
		L = 4 m	2 ¹ /44 ²	10,4/228,8	2 ¹ /34 ²	11,76/200
D	PIPE TEE		10 ³ /300 ⁵	6,5/195	8 ³ /240 ⁵	6,15/184,3
E	SCREWED / CLAMPING RING		100 ⁴ /6000 ⁵	9,7/582	100 ⁴ /6000 ⁶	11,1/666
F	ANCHOR (2-PIECE SET)	-	-	-	-	-
G	COTTER PIN	-	-	-	50	8
H	FLOW OUT COMPONENT	ANGLE = 60 ⁰	20 ³ /600 ⁵	7/168	16 ³ /384 ⁵	7/168
I	DOWNPIPE WITH FLANGE		12 ³ /360 ⁵	7,68/230,5	16 ³ /480 ⁵	5,28/158,4
J	RAINWATER CATCHER		10 ³ /300 ⁵	5,7/171	16 ³ /480 ⁵	5,28/158,4

¹ fail sleeve

² metal stand 80 cm/ element length/ 80 cm

³ carton 40 cm / 40 cm / 40 cm

⁴ carton 40 cm / 40 cm / 16 cm

⁵ EURO pallet 80 cm / 120 cm / 200 cm

⁶ EURO pallet 80 cm / 120 cm / 84 cm



CONTACT



Siedziba:

RRS Sp. z o.o. S.K.A.
ul. Reymonta 2,
77-400 Złotów, Polska
NIP: 767 469 86 17
REGON: 302576999

Sąd Rejonowy Poznań Nowe Miasto i Wilda IX Wydz. Gospodarczy Krajowego Rejestru Sądowego
nr. KRS 0000484929 Kapitał Zakładowy 50,000PLN, Kapitał wpłacony 12,500PLN

Produkcja:

ul. Radarowa 165
80-298 Gdańsk, Polska

T: +48 58 340 20 00
F: +48 58 340 20 90
E-mail: info@raiko.com

